

LICENSING SUB – COMMITTEE

10 March 2010

Report of the Head of Legal Services

Contact Officer: John Myall. Tel No: 01962 848443

Application : Premises Licence

Knowle Village Hall, Knowle Avenue, Knowle

Part A.	Report	<i>Buff</i>
1	Application	
2	Responsible Authorities	
3	Interested Parties	
4	Observations	
5	Conditions	
6	Other Considerations	
Part B.	Appendices	
Appendix 1	Application	<i>White</i>
Appendix 2	Representations from Interested Parties	<i>Cream</i>
Appendix 3	Other Appendices	<i>White</i>

Part A.**1. Application**

Applicant: Knowle Community Buildings Association

Premises: Knowle Village Hall

1.1 This is an application under section 17 of the Licensing Act 2003 for a new premises licence for Knowle Village hall.

1.2 The application is to provide the following licensable activities on a maximum of six occasions per year:-

Plays

Films

Indoor Sporting Events

Live Music

Recorded Music

Performances of Dance

Provision of facilities for making music

Provision of facilities for dancing

Supply of Alcohol (consumption on premises only)

1.3 The Operating Schedule, copied at Appendix 1, proposes the Relevant Licensable Activities.

1.4 The premises is a listed building which was formerly the Knowle Hospital chapel. It is situated in a residential area and surrounded by dwelling houses.

1.5 Representations were received from four interested parties covering all licensing objectives. One representation has since been withdrawn.

1.6 Notice of the application was displayed outside of the premises for a period of 28 days until 17 February 2010, and advertised in the Knowle Village Post on 23 January 2010.

1.7 Hearing notices were sent to all parties on 22 February 2010.

Designated Premises Supervisor

If the application is granted, Section 41 D (3) Licensing Act 2003 would apply. The mandatory condition relating to the designated premises supervisor would be disapplied and the management committee would be responsible for the sale of alcohol.

Steps to promote the Licensing Objectives

Please see Section Q Appendix 1.

Relevant Representations

2. Responsible Authorities

All of the Responsible Authorities have been served with a copy of the application. The representations received are as follows:

Head of Environment

No representations received.

Hampshire Constabulary

No representations received.

Hampshire Fire and Rescue Service

No representations received.

Child Protection Team

No representations received.

Head of Building Control

No representations received.

Head of Safety Standards

No representations received.

3. Interested Parties

- 3.1 Representations have been received from three interested parties which are attached at Appendix 2.

4. Observations

The Sub-Committee is obliged to determine this application with a view to promoting the Licensing Objectives:

- The prevention of crime and disorder
- Public safety
- The prevention of public nuisance
- The protection of children from harm

In making its decision, the Sub-Committee is also obliged to have regard to the National Guidance and the Council's Licensing Policy.

The Sub-Committee must have regard to all of the representations.

The Sub-Committee must take such of the following steps it considers necessary to promote the Licensing Objectives:

1. Grant the licence subject to conditions in accordance with the operating schedule (modified to such extent as the authority considers necessary for the promotion of the licensing objectives) and the mandatory conditions;
2. exclude from the scope of the licence any of the licensable activities to which the application relates;
3. refuse to specify a person in the licence as the premises supervisor;
4. reject the application.

Terminal hours

The Sub-Committee should take account of the National Guidance and the Council's Licensing Policy with regard to terminal hours and take such steps as it considers necessary to promote the Licensing Objectives.

(Licensing Policy Part 4, A8)

Licensing Objectives.

Crime and Disorder

The Sub-Committee should consider any necessary conditions to prevent crime and public disorder relating to the premises having regard to the operating schedule and the observations of the interested parties.

(Licensing Policy 1.6, 2.11, 2.17)

Public Safety

The Sub-Committee should consider any necessary conditions relating to public safety having regard to the operating schedule and the observations of the interested parties.

(Licensing Policy Part 4, B3, B4)

Public Nuisance

The Sub-Committee should consider any necessary conditions to prevent public nuisance caused by noise and light pollution from the premises having regard to the operating schedule and the observations of the interested parties.

(Licensing Policy Part 4, Section C)

Protection of Children

The Sub-Committee should consider any necessary conditions for the Protection of Children having regard to the Operating Schedule.

(Licensing Policy Part 4, D6, D7)

Human Rights

It is considered that Articles 6 (right to a fair trial) 8 (right to respect for private and family life) and Article 1 of the First Protocol (right to peaceable enjoyment of possessions) may be relevant. As there is a right of appeal to the Magistrates' Court, it is considered that there would be no infringement of Article 6. Article 8 is relevant, insofar as the nearby residents could claim that this right would be infringed by disturbance from customers. This should be balanced against the applicants' right to use of their premises under Article 1 of the First Protocol. Interference with these rights is permitted, where this interference is lawful, necessary in a democratic society, and proportionate. Likewise, the residents may argue that their rights under Article 1 of the First Protocol would be infringed. If conditions are imposed, there should be no interference with any convention rights. To the extent that any interference may occur, it would be justifiable in a democratic society, and proportionate.

5. Conditions

Mandatory Conditions

Under the Licensing Act 2003, the following conditions must be imposed on the Premises Licence in any event:-

1. Every supply of alcohol under the premises licence must be authorised by the management committee.
2. Where individuals are required on premises to carry out security activities, they must be licensed by the Security Industry Authority.
3. No film shall be exhibited unless it has received a U, PG, 12, 15 or 18 certificate from the British Board of Film Classification, or it is a current newsreel which has not been submitted to the British Board of Film Classification. The admission of children shall be restricted in accordance with the recommendations of the British Board of Film Classification.

Possible Conditions

If the application is granted, the Sub-Committee may wish to consider the following conditions to reflect the Operating Schedule:

Operating Hours

1. The hours the premises may be used for regulated entertainment shall be:

Plays

Monday to Sunday 1200 to 2200 each day

Films

Monday to Sunday 1100 to 2230 each day

Indoor Sporting Events

Monday to Sunday 1000 to 2300 each day

Live Music

Recorded Music

Monday to Sunday 1000 to 2300 each day

Christmas Eve 1000 to 0100

New Years Eve 1000 to 0100

Performances of Dance

Monday to Sunday	1000 to 2330 each day
Christmas Eve	1000 to 0100
New Years Eve	1000 to 0100

Provision of facilities for making music

Monday to Sunday	1000 to 2200 each day
-------------------------	------------------------------

Provision of facilities for dancing

Monday to Sunday	1000 to 2330 each day
Christmas Eve	1000 to 0100
New Years Eve	1000 to 0100

Supply of Alcohol (consumption on premises only)

Monday to Sunday	1200 to 2300 each day
Christmas Eve	1200 to 0100
New Years Eve	1200 to 0100

All Licensing Objectives

There shall be no more than six events per calendar year. The licence holder shall notify the licensing authority in writing of such events no less than 14 days in advance of the event.

Crime and Disorder

1. None

Public Safety

1. None

Public Nuisance

1. All doors and windows that are capable of being opened directly to the outside of the premises shall not be kept open whilst the premises are in use for the purposes of regulated entertainment.
2. Whilst music is being played as part of regulated entertainment, the licensee or appointed member of staff shall check periodically that noise levels are acceptable. Such monitoring shall be carried out at the boundary of the premises to ensure that local residents are not likely to be disturbed.

3. Staff shall be given appropriate instructions and training to encourage customers to leave the premises quietly and not to loiter in the vicinity of the premises so as to minimize disturbance to local residents.
4. A noise limiter shall be installed, calibrated and maintained to the satisfaction of the Head of Environment to control all amplified entertainment.
5. All events shall be restricted to the inside of the premises.

Protection of Children

1. No child shall be permitted at an event on the premises unless accompanied by an adult.

6. Other Considerations

Corporate Strategy (Relevance To:)

This report covers issues which relate to Safe and Strong Communities.

Resource Implications

A licence fee of £100 has been received. It is anticipated that an appropriate level of officer attendance will be provided within the existing budget.

Appendices

1. Application by The Knowle Community Buildings Association
2. Representations by Interested Parties
3. Map of premises location.



Winchester
City Council

RECEIVED

19 JAN 2010

02/02 No 5184

City Offices
Colebrook Street
Winchester
SO23 9LJ

**Application for a premises licence to be granted
under the Licensing Act 2003**

PLEASE READ THE FOLLOWING INSTRUCTIONS FIRST

Before completing this form please read the guidance notes at the end of the form.

If you are completing this form by hand please write legibly in block capitals. In all cases ensure that your answers are inside the boxes and written in black ink. Use additional sheets if necessary.

You may wish to keep a copy of the completed form for your records.

We The Knowle Community Buildings Association

(Insert name(s) of applicant)

apply for a premises licence under section 17 of the Licensing Act 2003 for the premises described in Part 1 below (the premises) and I/we are making this application to you as the relevant licensing authority in accordance with section 12 of the Licensing Act 2003

Part 1 – Premises Details

Postal address of premises or, if none, ordnance survey map reference or description:			
Knowle Village Hall, Knowle Avenue, Knowle Village.			
Post town	Fareham	Post code	PO17 5DG
Telephone number at premises (if any)		01329 834301	
Non-domestic rateable value of premises		£10,000	

Part 2 - Applicant Details

Please state whether you are applying for a premises licence as
Please tick yes

- a) an individual or individuals * please complete section (A)
- b) a person other than an individual *
- i. as a limited company please complete section (B)
 - ii. as a partnership please complete section (B)
 - iii. as an unincorporated association or please complete section (B)
 - iv. other (for example a statutory corporation) please complete section (B)
- c) a recognised club please complete section (B)
- d) a charity please complete section (B)
- e) the proprietor of an educational establishment please complete section (B)
- f) a health service body please complete section (B)
- g) a person who is registered under Part 2 of the Care Standards Act 2000 (c14) in respect of an independent hospital please complete section (B)
- h) the chief officer of police of a police force in England and Wales please complete section (B)

* If you are applying as a person described in (a) or (b) please confirm:

Please tick yes

- I am carrying on or proposing to carry on a business which involves the use of the premises for licensable activities; or
- I am making the application pursuant to a
 - statutory function or
 - a function discharged by virtue of Her Majesty's prerogative

(A) INDIVIDUAL APPLICANTS (fill in as applicable)

Mr <input type="checkbox"/>	Mrs <input type="checkbox"/>	Miss <input type="checkbox"/>	Ms <input type="checkbox"/>	Other Title (for example, Rev)	
Surname			First names		
I am 18 years old or over				<input type="checkbox"/>	Please tick yes
Current postal address if different from premises address					
Post Town		Postcode			
Daytime contact telephone number					
E-mail address (optional)					

SECOND INDIVIDUAL APPLICANT (if applicable)

Mr <input type="checkbox"/>	Mrs <input type="checkbox"/>	Miss <input type="checkbox"/>	Ms <input type="checkbox"/>	Other Title (for example, Rev)	
Surname			First names		
I am 18 years old or over				<input type="checkbox"/>	Please tick yes
Current postal address if different from premises address					
Post Town		Postcode			
Daytime contact telephone number					
E-mail address (optional)					

(B) OTHER APPLICANTS

Please provide name and registered address of applicant in full. Where appropriate please give any registered number. In the case of a partnership or other joint venture (other than a body corporate), please give the name and address of each party concerned.

Name Knowle Community Buildings Association
Address Knowle Village Hall, Knowle Avenue, Knowle Village, Fareham, PO17 5DG
Registered number (where applicable) None
Description of applicant (for example, partnership, company, unincorporated association etc.) Unincorporated Association
Telephone number (if any)
E-mail address (optional)

Part 3 Operating Schedule

When do you want the premises licence to start?

Day		Month		Year			
0	1	0	3	2	0	1	0

If you wish the licence to be valid only for a limited period, when do you want it to end?

Day		Month		Year			

Please give a general description of the premises (please read guidance note1)

This is a listed red brick building that was originally the chapel of the old Knowle Asylum. In 2002 it was converted to become the temporary community center. It is currently leased by the Knowle Community Buildings Association from the owners, Berkeley Homes.

It is a substantial single storey detached building in a residential location. It still has the appearance of the church it once was.

Hampshire Fire and Rescue Authority licence the building as being suitable for use by up to 220 persons.

If 5,000 or more people are expected to attend the premises at any one time, please state the number expected to attend.

What licensable activities do you intend to carry on from the premises?

(Please see sections 1 and 14 of the Licensing Act 2003 and Schedules 1 and 2 to the Licensing Act 2003)

Provision of regulated entertainment

Please tick yes

- a) plays (if ticking yes, fill in box A)
- b) films (if ticking yes, fill in box B)
- c) indoor sporting events (if ticking yes, fill in box C)
- d) boxing or wrestling entertainment (if ticking yes, fill in box D)
- e) live music (if ticking yes, fill in box E)
- f) recorded music (if ticking yes, fill in box F)
- g) performances of dance (if ticking yes, fill in box G)

h) anything of a similar description to that falling within (e), (f) or (g)
(if ticking yes, fill in box H)



Provision of entertainment facilities:

i) making music (if ticking yes, fill in box I)



j) dancing (if ticking yes, fill in box J)



k) entertainment of a similar description to that falling within (i) or (j)
(if ticking yes, fill in box K)



Provision of late night refreshment (if ticking yes, fill in box L)



Supply of alcohol (if ticking yes, fill in box M)



In all cases complete boxes N, O and P

A

Plays Standard days and timings (please read guidance note 6)			Will the performance of a play take place indoors or outdoors or both – please tick (please read guidance note 2)	Indoors	<input checked="" type="checkbox"/>
				Outdoors	<input type="checkbox"/>
				Both	<input type="checkbox"/>
Day	Start	Finish	Please give further details here (please read guidance note 3)		
Mon	1200	2200	This is a general request to cover the use of the premises for community plays and may involve the use of amplified music. No specific projects fitting this criteria are yet planned.		
Tue	1200	2200			
Wed	1200	2200	State any seasonal variations for performing plays (please read guidance note 4)		
Thur	1200	2200	It is reasonable to assume that there may be seasonal variations. By way of example it could be anticipated that Nativity Plays will take place around Christmas. However nothing is planned.		
Fri	1200	2200	Non standard timings. Where you intend to use the premises for the performance of plays at different times to those listed in the column on the left, please list (please read guidance note 5)		
Sat	1200	2200	The time span has been left intentionally broad to encompass any potential play or event.		
Sun	1200	2200			

B

Films Standard days and timings (please read guidance note 6)			<u>Will the exhibition of films take place indoors or outdoors or both – please tick</u> (please read guidance note 2)	Indoors	<input checked="" type="checkbox"/>
				Outdoors	<input type="checkbox"/>
				Both	<input type="checkbox"/>
Day	Start	Finish	<u>Please give further details here</u> (please read guidance note 3)		
Mon	1100	2230	Again until such time as we obtain a licence we have not made any plans. Suggestions for future events include the showing of popular films in the evening and Saturday film clubs for children. The sound and music will be amplified.		
Tue	1100	2230			
Wed	1100	2230	<u>State any seasonal variations for the exhibition of films</u> (please read guidance note 4)		
Thur	1100	2230	None		
Fri	1100	2230	<u>Non standard timings. Where you intend to use the premises for the exhibition of films at different times to those listed in the column on the left, please list</u> (please read guidance note 5)		
Sat	1100	2230	The time span has been left intentionally broad to encompass any potential event.		
Sun	1100	2230			

C

Indoor sporting events Standard days and timings (please read guidance note 6)			Please give further details (please read guidance note 3) The hall is already used for table tennis, pilates and badminton. Whilst no 'pay to view' sporting events are envisaged there is potential for such events in the future.
Day	Start	Finish	
Mon	1000	2300	
Tue	1000	2300	State any seasonal variations for indoor sporting events (please read guidance note 4)
Wed	1000	2300	None
Thur	1000	2300	Non standard timings. Where you intend to use the premises for indoor sporting events at different times to those listed in the column on the left, please list (please read guidance note 5)
Fri	1000	2300	None
Sat	1000	2300	
Sun	1000	2300	

D

Boxing or wrestling entertainments Standard days and timings (please read guidance note 6)			<u>Will the boxing or wrestling entertainment take place indoors or outdoors or both – please tick</u> (please read guidance note 2)	Indoors	<input type="checkbox"/>
				Outdoors	<input type="checkbox"/>
				Both	<input type="checkbox"/>
Day	Start	Finish			
Mon			<u>Please give further details here</u> (please read guidance note 3)		
Tue					
Wed			<u>State any seasonal variations for boxing or wrestling entertainment</u> (please read guidance note 4)		
Thur					
Fri			<u>Non standard timings. Where you intend to use the premises for boxing or wrestling entertainment at different times to those listed in the column on the left, please list</u> (please read guidance note 5)		
Sat					
Sun					

E

Live music Standard days and timings (please read guidance note 6)			<u>Will the performance of live music take place indoors or outdoors or both - please tick</u> (please read guidance note 2)	Indoors	<input checked="" type="checkbox"/>
				Outdoors	<input type="checkbox"/>
				Both	<input type="checkbox"/>
Day	Start	Finish	<u>Please give further details here</u> (please read guidance note 3)		
Mon	1000	2300	Again no particular event is planned so the times have been left wide. It is reasonable to expect that such events would occur mainly in the evenings but the possibility of children's events, earlier in the day, exists. The majority of such music will be amplified.		
Tue	1000	2300			
Wed	1000	2300	<u>State any seasonal variations for the performance of live music</u> (please read guidance note 4)		
Thur	1000	2300	The applicant may make seasonal variations on Christmas Eve and New years Eve annually. On these two occasions it would be desirable for the performance to take place until 1am.		
Fri	1000	2300	<u>Non standard timings. Where you intend to use the premises for the performance of live music at different times to those listed in the column on the left, please list</u> (please read guidance note 5)		
Sat	1000	2300	The applicant may make seasonal variations on Christmas Eve and New years Eve annually. On these two occasions it would be desirable for the performance to take place until 1am.		
Sun	1000	2300			

F

Recorded music Standard days and timings (please read guidance note 6)			<u>Will the playing of recorded music take place indoors or outdoors or both – please tick</u> (please read guidance note 2)	Indoors	<input checked="" type="checkbox"/>
				Outdoors	<input type="checkbox"/>
				Both	<input type="checkbox"/>
Day	Start	Finish	<u>Please give further details here</u> (please read guidance note 3)		
Mon	1000	2300	Recorded, and therefore amplified, music will be used for the majority of events.		
Tue	1000	2300			
Wed	1000	2300	<u>State any seasonal variations for the playing of recorded music</u> (please read guidance note 4)		
Thur	1000	2300	The applicant may make seasonal variations on Christmas Eve and New years Eve annually. On these two occasions it would be desirable for the performance to take place until 1am.		
Fri	1000	2300			
Sat	1000	2300	<u>Non standard timings. Where you intend to use the premises for the playing of recorded music at different times to those listed in the column on the left, please list</u> (please read guidance note 5)		
Sun	1000	2300	The applicant may make seasonal variations on Christmas Eve and New years Eve annually. On these two occasions it would be desirable for the performance to take place until 1am.		

G

Performances of dance Standard days and timings (please read guidance note 6)			<u>Will the performance of dance take place indoors or outdoors or both – please tick</u> (please read guidance note 2)	Indoors	<input checked="" type="checkbox"/>
				Outdoors	<input type="checkbox"/>
				Both	<input type="checkbox"/>
Day	Start	Finish	<u>Please give further details here</u> (please read guidance note 3)		
Mon	1000	2330	Various community dance classes are held in the hall and it is hoped that these can be extended to shows. It is also reasonable to expect that events such as discos and parties will be held in the hall on a regular basis.		
Tue	1000	2300			
Wed	1000	2330	<u>State any seasonal variations for the performance of dance</u> (please read guidance note 4)		
Thur	1000	2330	The applicant may make seasonal variations on Christmas Eve and New years Eve annually. On these two occasions it would be desirable for the performance to take place until 1am.		
Fri	1000	2330			
Sat	1000	2330	<u>Non standard timings. Where you intend to use the premises for the performance of dance at different times to those listed in the column on the left, please list</u> (please read guidance note 5)		
Sun	1000	2330	The applicant may make seasonal variations on Christmas Eve and New years Eve annually. On these two occasions it would be desirable for the performance to take place until 1am.		

H

Anything of a similar description to that falling within (e), (f) or (g) Standard days and timings (please read guidance note 6)			<u>Please give a description of the type of entertainment you will be providing</u>		
Day	Start	Finish	<u>Will this entertainment take place indoors or outdoors or both – please tick</u> (please read guidance note 2)	Indoors	<input type="checkbox"/>
Mon				Outdoors	<input type="checkbox"/>
				Both	<input type="checkbox"/>
Tue			<u>Please give further details here</u> (please read guidance note 3)		
Wed					
Thur					
Fri			<u>State any seasonal variations for entertainment of a similar description to that falling within (e), (f) or (g)</u> (please read guidance note 4)		
Sat					
Sun					
			<u>Non standard timings. Where you intend to use the premises for the entertainment of a similar description to that falling within (e), (f) or (g) at different times to those listed in the column on the left, please list</u> (please read guidance note 5)		

Provision of facilities for making music Standard days and timings (please read guidance note 6)			Please give a description of the facilities for making music you will be providing The facilities could be hired to groups wishing to practise, perform or record music.	
			Will the facilities for making music be indoors or outdoors or both – please tick (please read guidance note 2)	
			Indoors	<input checked="" type="checkbox"/>
			Outdoors	<input type="checkbox"/>
			Both	<input type="checkbox"/>
Day	Start	Finish	Please give further details here (please read guidance note 3) The nature of music means that there is likely to be some amplification. We would not allow the recording or practice of music at antisocial times and would require such activity to cease before 10pm.	
Mon	1000	2200		
Tue	1000	2200	State any seasonal variations for the provision of facilities for making music (please read guidance note 4)	
Wed	1000	2200		
Thur	1000	2200	None	
Fri	1000	2200		
Sat	1000	2200	Non standard timings. Where you intend to use the premises for provision of facilities for making music at different times to those listed in the column on the left, please list (please read guidance note 5)	
Sun	1000	2200		
			None	

J

Provision of facilities for dancing Standard days and timings (please read guidance note 6)			Will the facilities for dancing be indoors or outdoors or both – please tick (see guidance note 2)	Indoors <input checked="" type="checkbox"/>
				Outdoors <input type="checkbox"/>
				Both <input type="checkbox"/>
Day	Start	Finish	<u>Please give a description of the facilities for dancing you will be providing</u> Various community dance classes are held in the hall and it is hoped that these can be extended to shows. It is also reasonable to expect that events such as discos and parties will be held in the hall on a regular basis.	
Mon	1000	2330	<u>Please give further details here (please read guidance note 3)</u> Any music used is very likely to be amplified.	
Tue	1000	2330		
Wed	1000	2330	<u>State any seasonal variations for providing dancing facilities (please read guidance note 4)</u>	
Thur	1000	2330	The applicant may make seasonal variations on Christmas Eve and New years Eve annually. On these two occasions it would be desirable for the performance to take place until 1am.	
Fri	1000	2330	<u>Non standard timings. Where you intend to use the premises for the provision of facilities for dancing entertainment at different times to those listed in the column on the left, please list (please read guidance note 5)</u>	
Sat	1000	2330		
Sun	1000	2330	The applicant may make seasonal variations on Christmas Eve and New years Eve annually. On these two occasions it would be desirable for the performance to take place until 1am.	

K

Provision of facilities for entertainment of a similar description to that falling within i or j Standard days and timings (please read guidance note 6)			Please give a description of the type of entertainment facility you will be providing I believe this has already been covered in details above.		
Day	Start	Finish	Will the entertainment facility be indoors or outdoors or both – please tick (please read guidance note 2)	Indoors	<input type="checkbox"/>
Mon				Outdoors	<input type="checkbox"/>
				Both	<input type="checkbox"/>
Tue			Please give further details here (please read guidance note 3)		
Wed					
Thur			State any seasonal variations for the provision of facilities for entertainment of a similar description to that falling within i or j (please read guidance note 4)		
Fri					
Sat			Non standard timings. Where you intend to use the premises for the provision of facilities for entertainment of a similar description to that falling within i or j at different times to those listed in the column on the left, please list (please read guidance note 5)		
Sun					

L

Late night refreshment Standard days and timings (please read guidance note 6)			Will the provision of late night refreshment take place indoors or outdoors or both – please tick (please read guidance note 2)	Indoors	<input checked="" type="checkbox"/>
				Outdoors	<input type="checkbox"/>
				Both	<input type="checkbox"/>
Day	Start	Finish	<u>Please give further details here</u> (please read guidance note 3)		
Mon					
Tue			<u>State any seasonal variations for the provision of late night refreshment</u> (please read guidance note 4)		
Wed					
Thur			<u>Non standard timings. Where you intend to use the premises for the provision of late night refreshment at different times, to those listed in the column on the left, please list</u> (please read guidance note 5)		
Fri					
Sat					
Sun					

M

Supply of alcohol Standard days and timings (please read guidance note 6)			Will the supply of alcohol be for consumption (Please tick box) (please read guidance note 7)	On the premises	<input checked="" type="checkbox"/>
				Off the premises	<input type="checkbox"/>
				Both	<input type="checkbox"/>
Day	Start	Finish	State any seasonal variations for the supply of alcohol (please read guidance note 4)		
Mon	1200	2300	<p>For certain events it may be appropriate to provide alcohol and other refreshment. The applicant accept that the hall is not an suitable building for parties or events extending into the early hours of the morning so the application is restricted to more modest times. No seasonal variations can be foreseen.</p> <p>Non standard timings. Where you intend to use the premises for the supply of alcohol at different times to those listed in the column on the left, please list (please read guidance note 5)</p> <p>The only variation the applicant requests is for Christmas Eve and new Years Eve when it may be appropriate to extend the licence to 0100.</p>		
Tue	1200	2300			
Wed	1200	2300			
Thur	1200	2300			
Fri	1200	2300			
Sat	1200	2300			
Sun	1200	2300			

State the name and details of the individual whom you wish to specify on the licence as premises supervisor

Name Application made to disapply this condition.	
Address	
Postcode	
Personal Licence number (if known) Application made to disapply this condition.	
Issuing licensing authority (if known)	

N

Please highlight any adult entertainment or services, activities, other entertainment or matters ancillary to the use of the premises that may give rise to concern in respect of children (please read guidance note 8)

It would not be appropriate to hold events of this nature in this building. However historically there have been 'Ladies' nights in the hall and films may be shown where there are age restrictions.

In the event of such events being repeated the same course of action will apply as on the previous occasions.

Access to a ladies night would be adults only, those over 18 years of age and films would only be shown to the appropriate age group.

It is a simple task to prevent the viewing of events inside the hall from outside. Windows do not allow viewing from outside and there are two sets of doors to gain access to the building. Persons restricting entry to those described would staff the doors.

O

Hours premises are open to the public Standard days and timings (please read guidance note 6)			State any seasonal variations (please read guidance note 4) The premises are not generally open to the public. Access to specific events would be within those times given. Access outside those times would be by arrangement with the hall manager.
Day	Start	Finish	
Mon			Non-standard timings. Where you intend the premises to be open to the public at different times from those listed in the column on the left, please list (please read guidance note 5)
Tue			
Wed			
Thur			
Fri			
Sat			
Sun			

P Describe the steps you intend to take to promote the four licensing objectives:

a) General – all four licensing objectives (b,c,d,e) (please read guidance note 9)

Any event to which the public has access with or without payment will be supervised by one or more members of the committee. The number of supervisors will be dependent on the type of event and the number of people expected to attend. Public events will be restricted to ticket only.

The majority of events will also be supervised by the hall manager who is suitably qualified to conduct that role.

b) The prevention of crime and disorder

The principle concern of the applicant is that public order be maintained and that people attending events leave the building in a quite and orderly manner to minimise disturbance to the residents.

Whilst crime in Knowle is very low there are problem families and problem children but their identities are known and some are already excluded from the building.

Any incidents that require action by the Police will be reported to them.

c) Public safety

The building is restricted to 220 persons by Hampshire Fire service and that number will not be exceeded.

The building has regular fire inspections and is well served by emergency exits and a modern fire alarm system.

The layout of the building together with the restricted number of persons means that crush injuries are extremely unlikely. There is a comprehensive first aid kit and normally qualified first aiders on the premises.

All electrical appliances are annually PAT tested. Any equipment being brought onto the site by outside agencies is also required to be so tested.

The hall manager is health and safety trained and will risk assess on a regular basis.

d) The prevention of public nuisance

All persons leaving the premises are expected to conduct themselves in an orderly manner.

The building is used mainly by the community of Knowle and does not lend itself to visitors from outside as there is only parking for four vehicles. This means that hall users normally arrive on foot.

Any identified troublemakers will not be allowed access. Any problems inside the hall will be dealt with by responsible adults and, if necessary, those responsible will be required to leave.

The following points are all to prevent excess noise and/or nuisance and hopefully satisfy the requirements of local residents:

1. The applicants do not anticipate any high profile events that would attract outside crowds but any such event would be risk assessed and outside security brought in if it was deemed desirable. There will be no more than 6 events per annum.
2. All regulated entertainment shall cease at 2300 hours.

3. A noise limiter shall be installed, set and maintained to the satisfaction of the Head of Environment to control all amplified music.
4. All amplification equipment shall be routed through the calibrated noise limiter.
5. All doors and windows that are capable of being opened directly to the outside of the premises shall not be kept open whilst the premises are in use for the purposes of regulated entertainment.
6. Whilst music is being played as part of regulated entertainment, the licensee or appointed member of staff shall check periodically that noise levels are acceptable. Such monitoring shall be carried out at the boundary of the premises to ensure that local residents are not likely to be disturbed.

e) The protection of children from harm

Any child attending an event inside the hall is required to be accompanied by a responsible adult. On occasions adults leave children for particular events. At those times a register is kept and no child is allowed to leave before the return of that adult or their previously identified representative.

The doors are kept secured and supervised. A high adult/child ratio is also maintained dependant on the age of the child concerned.

Children would be excluded from unsuitable events and age restrictions would be observed in the event of films being shown.

Application is ongoing for a CRB check for the hall manager. Other hall supervisors for the various groups already have such checks in place.

Please tick yes

- I have made or enclosed payment of the fee
- I have enclosed the plan of the premises
- I have sent copies of this application and the plan to responsible authorities and others where applicable
- I have enclosed the consent form completed by the individual I wish to be premises supervisor, if applicable
- I understand that I must now advertise my application
- I understand that if I do not comply with the above requirements my application will be rejected

IT IS AN OFFENCE, LIABLE ON CONVICTION TO A FINE UP TO LEVEL 5 ON THE STANDARD SCALE, UNDER SECTION 158 OF THE LICENSING ACT 2003 TO MAKE A FALSE STATEMENT IN OR IN CONNECTION WITH THIS APPLICATION

Part 4 – Signatures (please read guidance note 10)

Signature of applicant or applicant's solicitor or other duly authorised agent (See guidance note 11). If signing on behalf of the applicant please state in what capacity.

Signature	
Date	15/1/10
Capacity	Chairman Knowle Community Buildings Association.

For joint applications signature of 2nd applicant or 2nd applicant's solicitor or other authorised agent. (please read guidance note 12). If signing on behalf of the applicant please state in what capacity.

Signature	
Date	15/1/10
Capacity	Secretary Knowle Community Buildings Association

Contact name (where not previously given) and postal address for correspondence associated with this application (please read guidance note 13)

Andrew Snow,
19, BoundaryWalk,
Knowle Village

Post town Fareham **Post code** PO17 5NQ

Telephone number (if any)

If you would prefer us to correspond with you by e-mail your e-mail address (optional)

Notes for Guidance

1. Describe the premises. For example the type of premises, its general situation and layout and any other information, which could be relevant to the licensing objectives. Where your application includes off-supplies of alcohol and you intend to provide a place for consumption of these off-supplies you must include a description of where the place will be and its proximity to the premises.
2. Where taking place in a building or other structure please tick as appropriate. Indoors may include a tent.
3. For example the type of activity to be authorised, if not already stated, and give relevant further details, for example (but not exclusively) whether or not music will be amplified or unamplified.
4. For example (but not exclusively), where the activity will occur on additional days during the summer months.
5. For example (but not exclusively), where you wish the activity to go on longer on a particular day e.g. Christmas Eve.
6. Please give timings in 24 hour clock (e.g. 16:00) and only give details for the days of the week when you intend the premises to be used for the activity.

7. If you wish people to be able to consume alcohol on the premises please tick on, if you wish people to be able to purchase alcohol to consume away from the premises please tick off. If you wish people to be able to do both please tick both.
8. Please give information about anything intended to occur at the premises or ancillary to the use of the premises which may give rise to concern in respect of children, regardless of whether you intend children to have access to the premises, for example (but not exclusively) nudity or semi-nudity, films for restricted age groups, the presence of gaming machines.
9. Please list here steps you will take to promote all four licensing objectives together.
10. The application form must be signed.
11. An applicant's agent (for example solicitor) may sign the form on their behalf provided that they have actual authority to do so.
12. Where there is more than one applicant, both applicants or their respective agents must sign the application form.
13. This is the address which we shall use to correspond with you about this application.

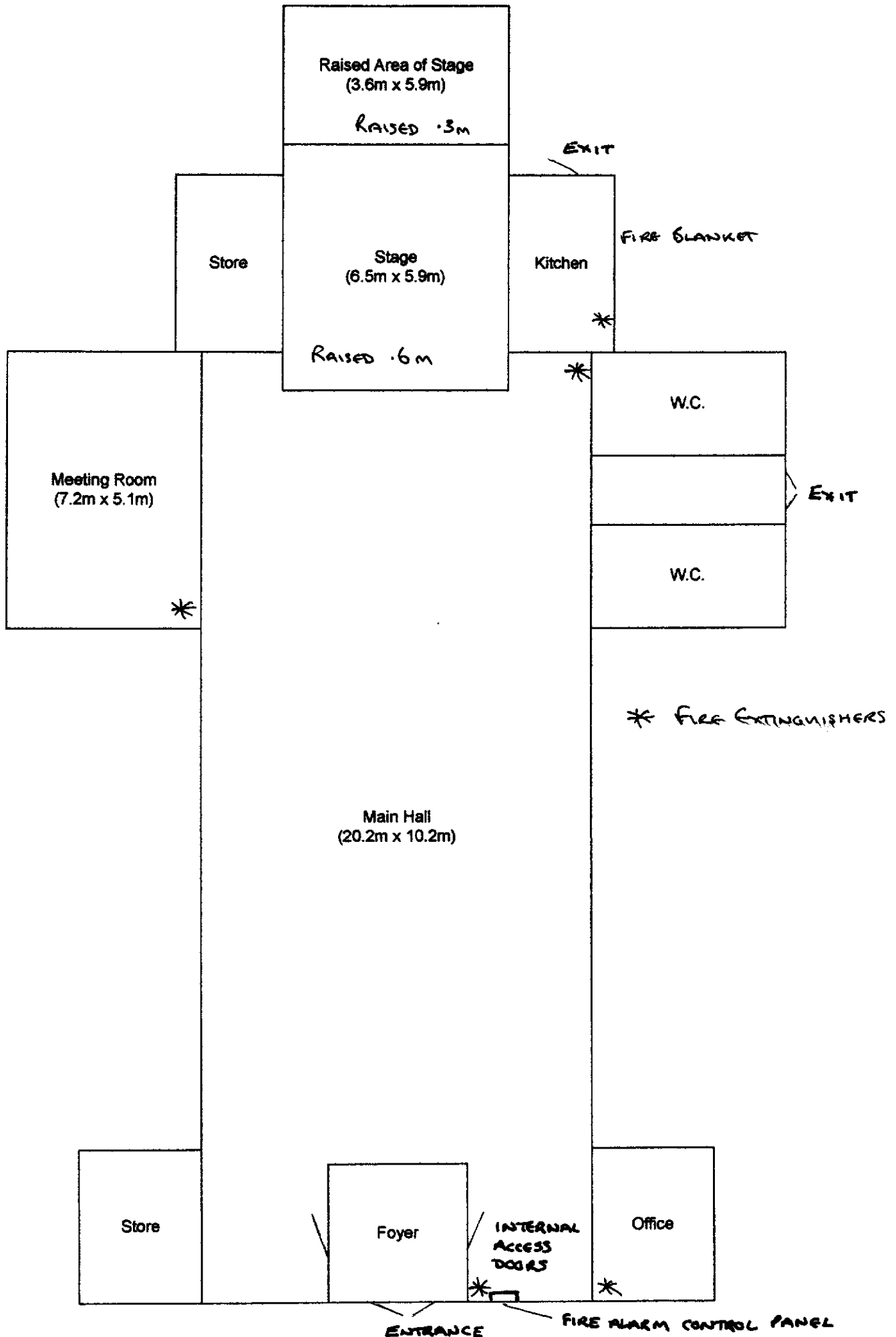

KNOWLE VILLAGE HALL – Layout & Approximate dimensions

John Myall

From: Amanda Johnson [REDACTED]
Sent: 30 January 2010 13:02
To: Licensing
Subject: knowle village hall application for a premisise licence

i live at number 11 greater horseshoe way . which is opposite the church , i have a 9 year old girl and as it is it is verry noisy at weekends . with partys and some times during the week when she has school . if this is aloud to happen there will be more noise . more fights from people from there . out side . from the hall . and il have to move . and i have ben here since it was buit . i was the first person t move in by 1 day in the village and intend to carry on living here . but i have to think of my daughter . many thans amanda johnson

Click [here](#) to report this email as spam.

John Myall

From: Annette Wolfe [REDACTED]
Sent: 14 February 2010 12:44
To: Licensing
Cc: [REDACTED]
Subject: <v9_SmartSaved/> Application for a premises licence - Knowle Village Hall, Knowle Ave, Knowle, Fareham
Follow Up Flag: Follow up
Due By: 22 February 2010 08:30
Flag Status: Flagged
Categories: SmartSaved
SmartSaved: win-edrms1_U394_D50_N198633

Dear Sir/Madam,

I am writing to you to voice my concerns over the application for a premises license for Knowle Village Hall, Knowle Avenue, Knowle, Fareham.

My objections to the licence concern primarily 4 of the items listed on the proposed purpose of the application:

- Live Music 1000 - 2300

- Recorded Music 1000 - 2300

- Provision of facilities for making music 1000 - 2200

- Supply of alcohol 1200 - 2300

If this licence were to be granted, I believe there would be a detrimental effect on public safety, a public nuisance would be created and serious concerns raised about the protection of children from harm. I would now like to explain my reason for stating this in this representation:-

1. The premises of Knowle Village Hall on Knowle Avenue are unsuitable for the purposes of live music, recorded music and the provision of facilities for making music. The building is not sound proofed and the windows and doors are regularly open, which allows and accentuates the sound/noise to permeate to local residences. This is noise pollution and a public nuisance and when residents are pursuing activities within their own homes or gardens, this is unacceptable. Where this licence to be granted and problems continue of an environmental health nature, it is a current problem that no one from environmental health is available to attend. I have an email from Therese Evans of Winchester City Council which states the following from Winchester Environmental Health dept:-

"I have been dealing with the Public Entertainments Licence Application as well as complaints from

the premises. I have visited, made an assessment and given advice to the Association on these matters. I am of the opinion that music events cannot take place at this venue after 11pm, without some alterations to the building and **EVEN BEFORE 11PM, AS IF NOT CONTROLLED PROPERLY, THEY WILL DISTURB MANY IMMEDIATE NEIGHBOURS. I HAVE ADVISED THE COMPLAINANTS OF THE SITUATION"**.

2. Parking remains an issue within the boundaries of Knowle Village and currently vehicles are parked on both sides of the road, on corners etc, which does concern both myself and others greatly as to the safety of both children and adults either playing or indeed trying to cross the road. This is a serious concern and the safety of the public is at risk both for pedestrians and drivers trying to negotiate what are already narrow roads with cars parked around blind corners. On several occasions I have also witnessed light goods vehicles, mounting the pavements to back up to the side door of the Village Hall for both loading and unloading purposes - surely this is unacceptable when pedestrians are trying to walk on that same pavement and is unsafe when that light goods vehicle then tries to back onto the road again? This is made worse when events finish at 11pm and it is dark when this is happening.

3. I should like to point out that when events are held in the Knowle Village Hall they do not always end promptly at 11pm and for local residents this does involve additional noise when people are leaving in their cars and equipment is being loaded into vehicles - sometimes noise can go on until midnight. This is a public nuisance. We have voiced our concerns over these issues to the Residents Association over the years, but this has to date been disregarded.

4. When events are held in the Knowle Village Hall, I have witnessed people standing outside the side door of the chapel drinking bottles of beer. I believe this is a public nuisance.

My representation also takes account of the fact that I strongly believe where this application to be granted, it would be absolutely contrary to the Charter of the Fundamental Rights of the European Union which sets out the rights of European citizens and all persons resident in the eu. They are based in particular on the fundamental rights and freedoms by the European Convention on Human Rights. Article 7 of chapter 1 Dignity clearly states that:-

" respect for private and family life everyone has the right to respect for his or her private and family life,home and communications".

Where this application to be granted i see no respect for my family or many others living nearby whose family and home life would be unrespected as our safety would be at risk and we would be subject to a public nuisance and our children potentially unprotected.

The European Union have stated that noise above a certain volume according to the European Environment Agency affects not only wellbeing, but also the health of citizens.

I should be pleased if you could inform me when this application is to be heard as I would like to attend and that this representation has been received.

Kind regards,

Mr and Mrs Trevor Wolfe
18 Pipistrelle Walk
Knowle Village
Knowle
PO17 5BE

CSS
RECEIVED

03 FEB 2010

FAO	REPLY BY	No.
-----	----------	-----

20 Pipistrelle Walk
Knowle
FAREHAM
Hampshire
PO17 5BE

2nd February 2010

Licensing Section
Winchester City Council
City Offices
Colebrook Street
Winchester
Hampshire
SO23 9LJ



Dear Sir/Madam,

**Re: Licensing Act 2003 - Application for a Premises Licence - Knowle Village Hall,
Knowle Avenue, Knowle, Fareham**

I write to object to the above Premises License application on the grounds that the following licensable activities are a 'public nuisance':

- Live Music 1000 - 2300
- Recorded Music 1000 - 2300
- Provision of facilities for making music 1000 - 2200

Previous complaints from local residents have been registered with the Environmental Health department of Winchester City Council due to excessive noise pollution from private functions held at Knowle Village Hall.

The building is located in a residential area and no provision was made for acoustic insulation when converting it from a chapel to a village hall. Whilst I understand that recent intervention from a local councillor has led to a minor reduction in noise levels, it is still an unacceptable venue for the playing of live and recorded music at any time.

Yours faithfully,

A large black rectangular redaction box covering the signature area.

Glen McEneny
BA (Hons) DipArch RIBA

Knowle Village Hall

Premises Licence



Winchester
City Council

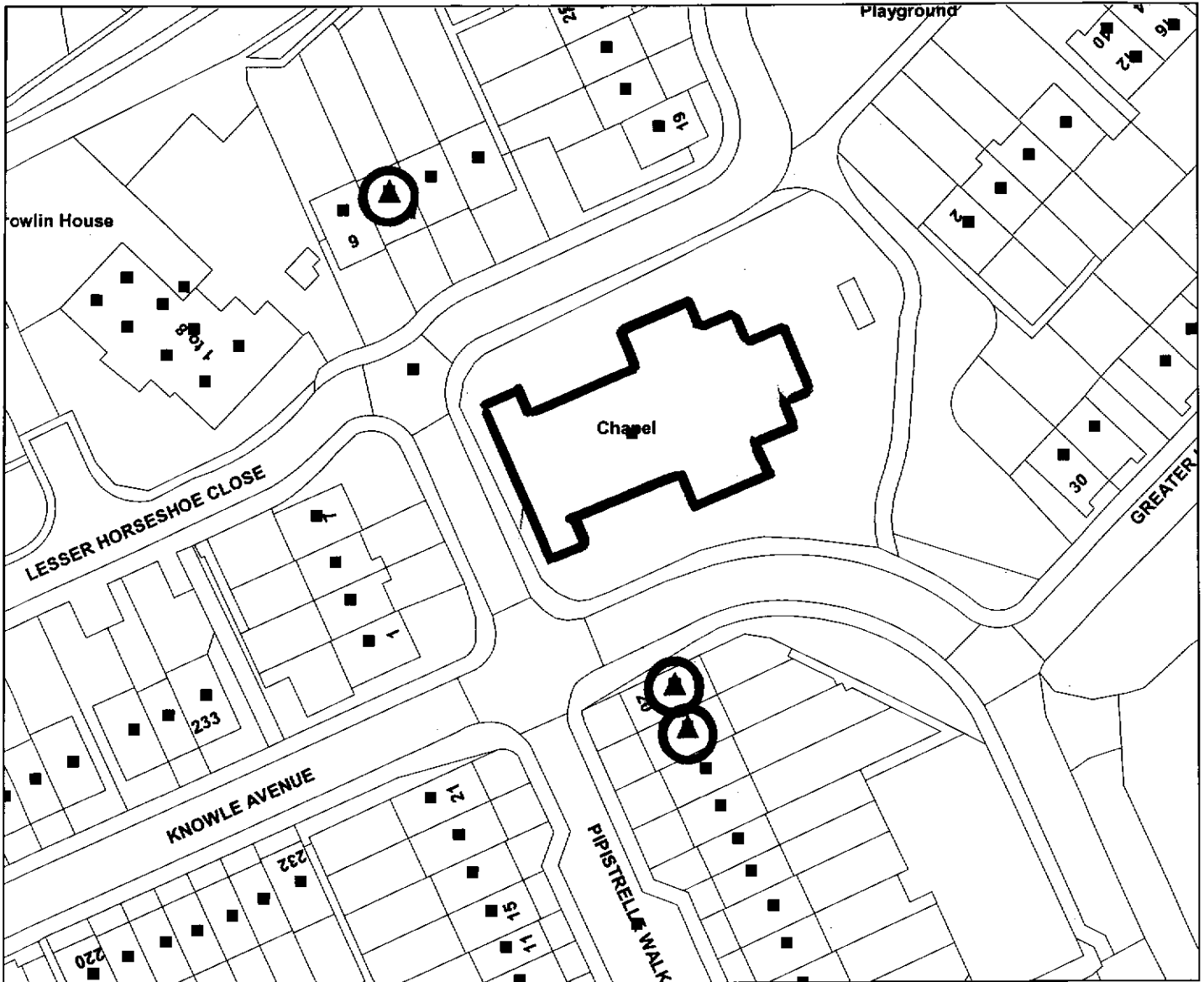

Legend

 Representations

Scale:

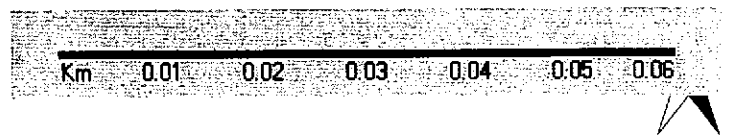

Reproduced from the Ordnance Survey map with the permission of the Controller of Her Majesty's Stationery Office © Crown Copyright. Unauthorised reproduction infringes Crown Copyright and may lead to prosecution or civil proceedings. Winchester City Council © 2007.

Organisation	Winchester City Council
Department	Legal Services
Comments	
Date	03 March 2010
SLA Number	00018301